

KEY TO GRAVES IN ST. JOHN'S CHURCH CEMETERY

- NO.
- |  |  |
|--|--|
| 1. Isabel Smith, 1796  | 39. Obadiah Seaman, 1862   |
| 2. Jemima Edwards, 1839 (1836)<br>("formerly wife of Henry C. Smith")                  | 40. F. A. S. 1861  |
| 3. Henry C. Smith, 1802 (1805)   | 41. A metal monument, bearing various<br>names of Seaman family. |
| 4. James M. Terry, 1812 (1817)   | 42. Mary Seaman, 1861  |
| 5. Edmond Terry, 1839  | 43. Matthew E. Seaman, 1845                                      |
| 6. John Harvey Vail, 1916  | 44. Edward Seaman, 1845  |
| 7. Richard Udall Vail, 1909  | 45. Emily Seaman 1840  |
| 8. Henry Sheldon Vail, 1857  | 46. Hannah Douglass, 1833  |
| 9. Anna Strong, 1871<br>(d. of Harvey and Anne Vail)                                   | 47. John Douglass, 1830  |
| 10. Anne Udall Vail, 1890  | 48. William Terry, 1821 (1824)                                   |
| 11. Harvey Wentworth Vail, 1863  | 49. William Brown, 1845  |
| 12. Henry M. Davis, 1851<br>(s. of Rev. Henry Davis)                                   | 50. Ruth Brown, 1858   |
| 13. Elizabeth Smith, 1877  | 51. Samuel Brown, 1876   |
| 14. William Smith, 1884  | 52. Amanda Terry, 1812   |
| 15. William Mazurle, 1859  | 53. Martha Terry, 1834   |
| 16. George Graham, 1938 (no stone)   | 54. Silas C. Terry, 1838   |
| 17. Mary Graham, 1938  | 55. William J. Morris, 1852                                      |
| 18. William H. Brown, 1859   | 56. Isaac Woodruff, 1813   |
| 19. Eleazar Hawkins, 1853  | 57. Jacob Morris, 1855   |
| 20. E. Josephine Hawkins, 1854   | 58. Amanda Woodruff, 1835  |
| 21. Franklin Smith, 1871, and<br>Mary Smith, 1874                                      | 59. Isaac C. Woodruff, 1838                                      |
| 22. Sarah Jane Edwards, 1869   | 60. William Nicoll, 1823   |
| 23. Lawrence Edwards, 1860   | 61. Sarah Greenly Nicoll<br>(1798-1887, w. of William Nicoll)    |
| 24. George E. Weeks, 1856 (no stone)   | 61a. Sarah Greenly Nicoll (1824-1830)                            |
| 25. Caroline Ketcham, 1845 (1842) (no stone)   | 61b. William Nicoll, 1844 (4 weeks)                              |
| 26. Penelope (Price), 1855<br>("relict" of George Price) (foot stone only,<br>no date) | 62. William Green, 1824  |
| 27. Harry Smith, 1845 (foot stone only, no date)                                       | 63. Mary Green, 1869   |
| 28. Temperence Green, 1847 (M. T. G. foot stone only)                                  | 64. Mary Green, 1849   |
| 29. Thomas Green, 1834 (F. T. G. foot stone only)                                      | 65. John D. Green, 1842  |
| 30. Mary E. Bunce, 1853  | 66. Nelson Strong, 1855 and<br>Louise Strong, 1885               |
| 31. Nancy Bell, 1822 (no stone)  | 67. Giorana Strong, 1839   |
| 31a. Jeremiah Terry, 1823  | 68. William Strong, 1862   |
| 31b. Elizabeth Terry 1795  | 69. Edward Smith, 1843 (1845)                                    |
| 32. Deborah Snedecor, 1835 (1833)  | 70. Hannah Maria Strong, 1816                                    |
| 33. Elizabeth Snedecor, 1835 (no stone)  | 71. Mary Ann Candee, 1859  |
| 34. Mary E. Snedecor, 1841   | 72. Josephine Rogers, 1855                                       |
| 35. Edwin Snedecor 1846 (no stone)   | 73. Harrison Clay Douglass, 1845                                 |
| 35a. Lewis N. Snedecor, 1840   | 74. E. N. D. (foot stone only, no date)                          |
| 36. Eliphalet Snedecor, 1861   | 75. Emma Strong, 1844  |
| 37. Sarah Seaman Snedecor, 1875 and<br>Cornelia Snedecor, 1880                         |  |
| 38. John H. Snedecor, 1861 (1864)<br>(killed in battle of Winchester, Va.)             |  |

ADDITIONAL INTERMENTS - Grave sites not plotted

- Sarah Woodruff, 1838 (no stone)  
 Silas C. Seaman, 1886 (no stone)  
 Franklin Seaman (no stone)  
 Helen Hegeman, 1838 (no stone)  
 Betsy Bell, 1793 (no stone)

The Ludlow Plot

- A. William Ludlow, 1915 (Admiral, U.S.N.)  
 B. Nicoll Ludlow, Jr., 1887  
 C. Frances Mary Thomas Ludlow, 1873  
 D. Frances Louisa Nicoll Ludlow, 1877 (1887) and  
 William Handy Ludlow, 1890  
 E. Annie M. Hayes, 1891  
 F. Newton Perkins Ludlow, 1858

NOTE: - Black dots indicate the head of the grave except in a few cases where the head cannot be determined.

Graves regularly extend toward the south-eastern boundary of the property, roughly parallel to the sides of the Church building, except graves E and F in the Ludlow plot, which lie north-east and south-west.

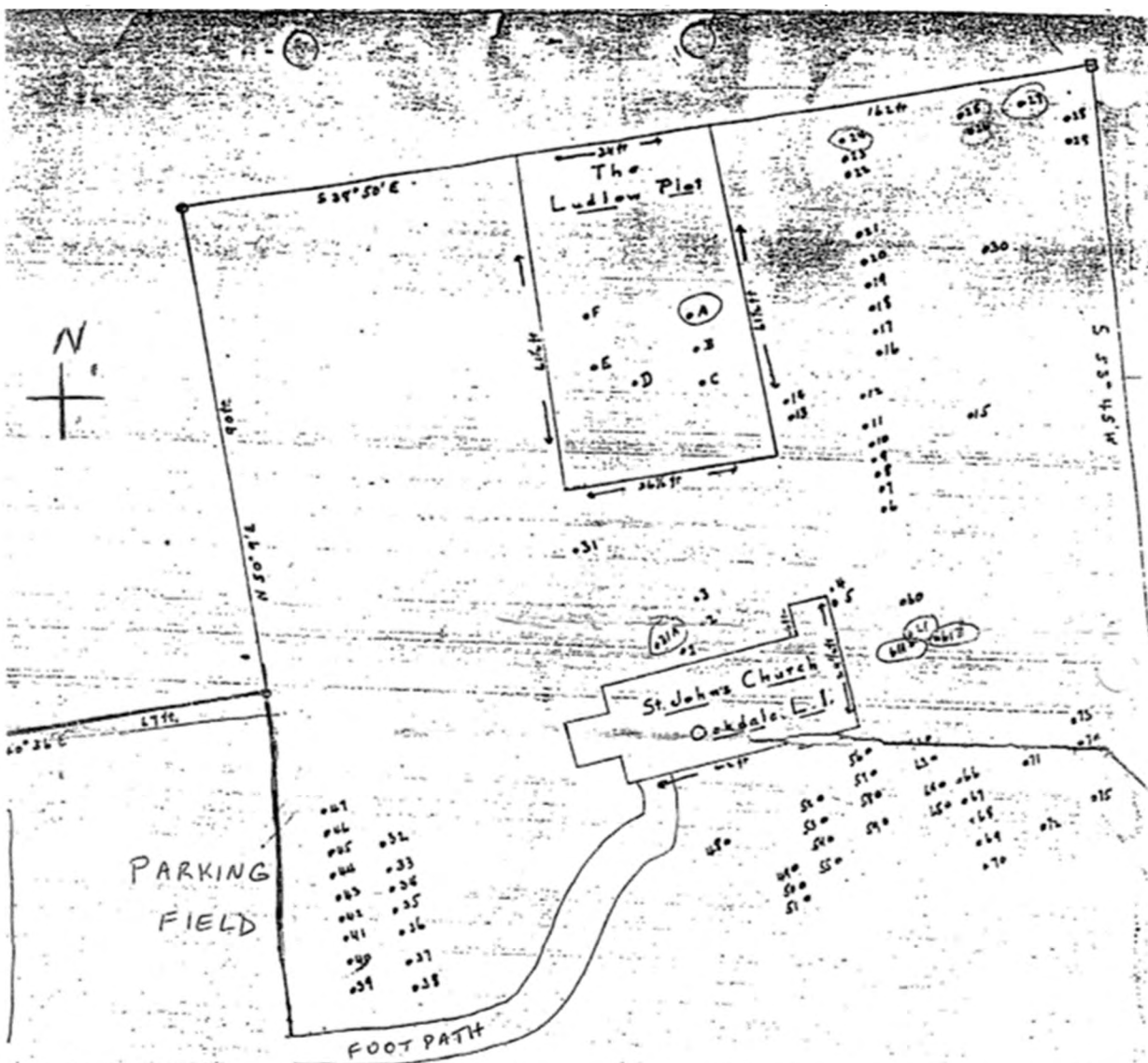

St. John's Episcopal Church

LIBERARD BLVD  
 Oakdale, Long Island  
 567-3464



Scale - 1/2" = 1 foot

AREA 0.53 Acre



11.40.00